

NOTES:

- 1 MAXIMUM OPERATING DEPTH: 3000MSW / 9843FSW
- 2 U/W CONNECTOR IS CUSTOMER SPECIFIED
- 3 WEIGHT IN AIR: 10.2LB / 4.6KG (EST.)
- IN SEAWATER: 5.8LB / 2.6KG (EST.)
- 4 DIMENSIONS IN INCHES
- 5 DIMENSIONS ARE NOMINAL
- 6 DO NOT SCALE

PROPRIETARY NOTICE

THIS DOCUMENT CONTAINS INFORMATION WHICH IS THE SOLE PROPERTY OF KONGSBERG MESOTECH Ltd. AND IS RECEIVED IN CONFIDENCE. ITS CONTENTS MAY NOT BE DISCLOSED OR REPRODUCED IN ANY WAY WITHOUT THE WRITTEN CONSENT OF KONGSBERG MESOTECH Ltd.

DO NOT SCALE DRAWING

APPROVALS		DATE
DRAWN	DL	05/07/20
REVISED	DL	06/02/27
CHECKED		
ENGR		
ISSUED		
CONFIDENTIAL DO NOT COPY		

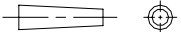

1.1	ECO 3881	06/02/27
ISS	DESCRIPTION	DATE
REVISIONS		
Kongsberg Mesotech Ltd.		
OUTLINE & INSTALLATION DRAWING - 3000m MODEL 1007 NARROW BEAM ALTIMETER		
SIZE B	NSCM NO 1C965	TYPE MD
DWG NO. 974-70391001	ISS 1.1	
SCALE: 11:25	W.O. NO.	SHEET 1 OF 1