

NOTES:  
 1. MAXIMUM OPERATING DEPTH: 4000msw / 13123fsw.  
 2. WEIGHT IN AIR: 9.0lbs / 4.1kg  
 WEIGHT IN SEAWATER: 3.9lbs / 1.8kg  
 3. DIMENSIONS IN INCHES.  
 4. DO NOT SCALE.

PROPRIETARY NOTICE  
 THIS DOCUMENT CONTAINS INFORMATION WHICH IS SOLE PROPERTY OF KONGSBERG MESOTECH LTD AND IS RECEIVED IN CONFIDENCE. ITS CONTENTS MAY NOT BE DISCLOSED OR REPRODUCED IN ANY WAY WITHOUT WRITTEN CONSENT OF KONGSBERG MESOTECH LTD.

DO NOT SCALE DRAWING.  
 CONFIDENTIAL. DO NOT COPY.

APPROVALS	NAME	DATE
DRAWN	DL	11/12/05
REVISED	--	--
CHECKED		
ENGR		
ISSUED		

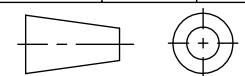

ISS	DESCRIPTION	DATE
REVISIONS		
	<b>Kongsberg Mesotech Ltd.</b>	
	<b>OUTLINE AND INSTALLATION DRAWING 1171 IMAGER, DUAL FREQUENCY</b>	
SIZE	NSCM NO	TYPE
B	1C965	MD
DWG. NO.	ISS	
975-21081001	1.0	
SCALE: 1:1	W.O. NO.	SHEET 1 OF 1